

PC Board Layout (t=1.60mm)
Component Side Shown

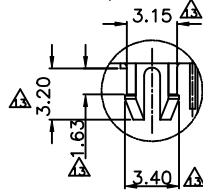

DRAWING MODIFY		DATE	REVISION RECORD			
REV	ECO	DESCRIPTION	DRFT	CHKD		
1		ADD RIB				
2		DRAWING MODIFY				
3		DRAWING MODIFY				
4		DRAWING MODIFY				
5		ADD TYPE				
6		ADD TYPE				
7		ADD TYPE				
8		ADD TYPE				
9		ADD TYPE				
10		ADD TYPE				
11		ADD TYPE				
12		ADD TYPE				
13		ADD TYPE				
14		ADD TYPE				
15		ADD TYPE				
16		ADD TYPE				
17		ADD TYPE				
18		ADD TYPE				
19		ADD TYPE				
20		ADD TYPE				
21		ADD TYPE				
22		ADD TYPE				
23		ADD TYPE				
24		ADD TYPE				
25		ADD TYPE				
26		ADD TYPE				
27		ADD TYPE				
28		ADD TYPE				
29		ADD TYPE				
30		ADD TYPE				
31		ADD TYPE				
32		ADD TYPE				
33		ADD TYPE				
34		ADD TYPE				
35		ADD TYPE				
36		ADD TYPE				
37		ADD TYPE				
38		ADD TYPE				
39		ADD TYPE				
40		ADD TYPE				
41		ADD TYPE				
42		ADD TYPE				
43		ADD TYPE				
44		ADD TYPE				
45		ADD TYPE				
46		ADD TYPE				
47		ADD TYPE				
48		ADD TYPE				
49		ADD TYPE				
50		ADD TYPE				
51		ADD TYPE				
52		ADD TYPE				
53		ADD TYPE				
54		ADD TYPE				
55		ADD TYPE				
56		ADD TYPE				
57		ADD TYPE				
58		ADD TYPE				
59		ADD TYPE				
60		ADD TYPE				
61		ADD TYPE				
62		ADD TYPE				
63		ADD TYPE				
64		ADD TYPE				
65		ADD TYPE				
66		ADD TYPE				
67		ADD TYPE				
68		ADD TYPE				
69		ADD TYPE				
70		ADD TYPE				
71		ADD TYPE				
72		ADD TYPE				
73		ADD TYPE				
74		ADD TYPE				
75		ADD TYPE				
76		ADD TYPE				
77		ADD TYPE				
78		ADD TYPE				
79		ADD TYPE				
80		ADD TYPE				
81		ADD TYPE				
82		ADD TYPE				
83		ADD TYPE				
84		ADD TYPE				
85		ADD TYPE				
86		ADD TYPE				
87		ADD TYPE				
88		ADD TYPE				
89		ADD TYPE				
90		ADD TYPE				
91		ADD TYPE				
92		ADD TYPE				
93		ADD TYPE				
94		ADD TYPE				
95		ADD TYPE				
96		ADD TYPE				
97		ADD TYPE				
98		ADD TYPE				
99		ADD TYPE				
100		ADD TYPE				

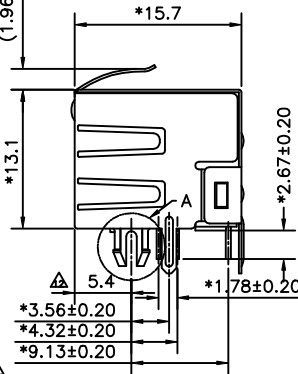
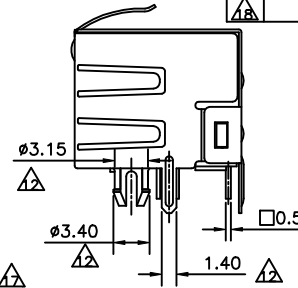
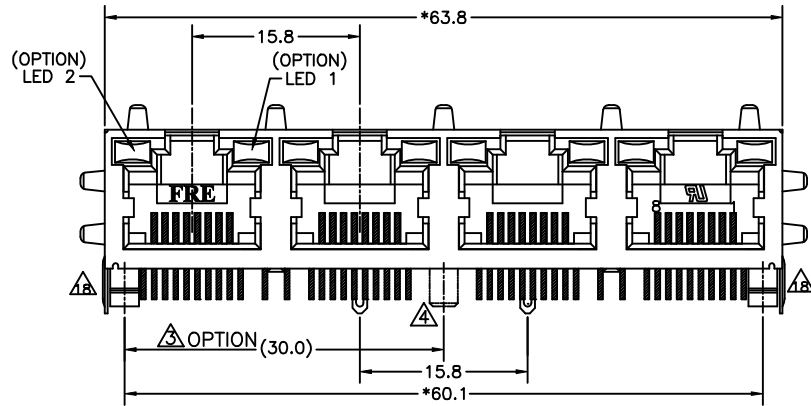
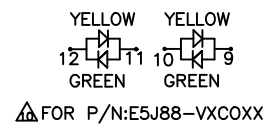
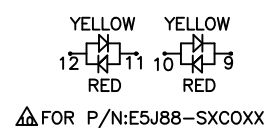
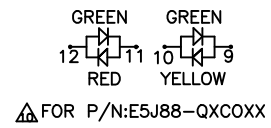
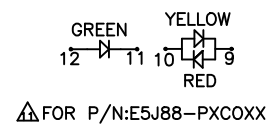
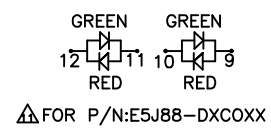
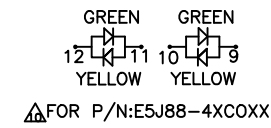
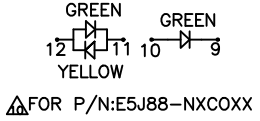

NOTES:

ELECTRICAL:

- VOLTAGE RATING : 125 VAC RMS.
- CURRENT RATING : 1.5 AMP.
- CONTACT RESISTANCE : 30 MILLIOHMS MAX.
- INSULATION RESISTANCE: 1000 MEGOHMS MIN @ 500 VDC.
- DIELECTRIC STRENGTH : 1000 VAC RMS 60Hz, 1MIN.
- LED RATINGS: FORWARD VOLTAGE: 2.2 VOLTS TYPICAL.
REVERSE VOLTAGE: 5 VOLTS MAXIMUM
- OPERATING: 750 CYCLES MIN.

MECHANICAL:

- HOUSING MATERIAL : PBT+30%.GF UL94V-0. COLOR-BLACK.
- INSERT MATERIAL : PBT+30%GF UL94V-0. COLOR-BLACK.
- BACK PLATE MATERIAL : PBT+30%GF. COLOR-BLACK.
- LED SIZE : 3.2*2.0*7.0*P=2.54mm.
- SHIELD MATERIAL : COPPER ALLOY 0.25mm THICKNESS PLATING NI.
- CONTACT MATERIAL : PHOSPHOR BRONZE 0.35mm THICKNESS OR $\phi 0.46$ mm.
- PLATING : GOLD PLATING OVER NICKEL.
- PCB RETENTION PRE-SOLDER : 1 LB MIN.
- PCB RETENTION POST-SOLDER: 10 LBS MIN.

ENVIRONMENTAL:

- STORAGE : -40°C TO +85°C.
- OPERATION: -40°C TO +85°C.

MATES WITH MODULAR PLUG CONFORMING TO FCC PART 68, SUBPART F.

CUL FILE No: E163191

PART NUMBER: E 5 J 8 8 - X X X X X X

1-LED1:GREEN ,LED2:YELLOW
 2-LED1:GREEN ,LED2:GREEN
 3-LED1:YELLOW ,LED2:GREEN
 4-LED1:G+Y ,LED2:G+Y
 5-LED1:RED ,LED2:GREEN
 7-LED1:YELLOW ,LED2:YELLOW
 D-LED1:G+R ,LED2:G+R
 E-LED1:GREEN ,LED2:RED
 N-LED1:GREEN ,LED2:G+Y
 P-LED1:Y+R ,LED2:GREEN
 Q-LED1:G+Y ,LED2:G+R
 S-LED1:Y+R ,LED2:Y+R
 V-LED1:Y+G ,LED2:Y+G
 K-LED1:G+Y ,LED2:GREEN

PLATING: 1-3u" 2-6u"
 3-15u" 4-30u" 5-50u"

1- PLATE Tin SHIELD, STAMP PIN, LED LONG 7.00
 2- PLATE Ni SHIELD, STAMP PIN, LED LONG 7.00
 3- PLATE Tin SHIELD, ROUND PIN, LED LONG 7.00
 4- PLATE Ni SHIELD, ROUND PIN, LED LONG 7.00

0-W/O LOGO
 6-W/ FRE&UL

4-4 PORTS W/O MIDDLE POLE
 C-4 PORTS W/ MIDDLE POLE

0-NO SHIELD
 1-NO TAB 2-TOP TABS.
 3-SIDE TABS.
 4-TOP TABS & SIDE TABS.

MM (INCH)	DFTO CZH	DATE	FULL RISE ELECTRONIC CO., LTD	
TOLERANCES EXCEPT AS NOTED	CHKD ASHELLY	DATE 2005/11/24	TITLE	
	MFO	DATE		
	APPV LUSHENG	DATE 2005/11/25	RJ45 SIDE ENTRY LED GANG JACK 4 PORTS	
	MATERIAL :		DRAWING NO. GE5J3017	
	ANGLES ±	QT'Y :	/PART NO. SEE NOTE	
	FINISH :	SCALE : 2:1	DO NOT SCALE DRAWING	
			SHEET 1 OF 1	